



MARSS

 MOBtronic™

AUTOMATIC MAN-OVERBOARD
DETECTION & RESCUE SUPPORT

INTELLIGENT SAFETY SOLUTION FOR WHEN IT MATTERS MOST

Millions of people travel via waterways every year. Man overboard events happen too often from vessels without an immediate detection and rescue.

MOBtronic provides 24/7 autonomous monitoring, detection tracking and response support for man overboard events.





ALL IN ONE MAN OVERBOARD DETECTION SYSTEM

OVER 95% PROBABILITY OF DETECTION

MOBtronic is an automated system for the instant detection, classification and rescue support of a human falling overboard a vessel or maritime structure.

Each MOBtronic unit is self contained and includes micro radars, thermal cameras with video analytics and automatic data processing boards. The system has been tried and tested extensively and provides a high level of accuracy with less than 3 nuisance activations per week, on average.

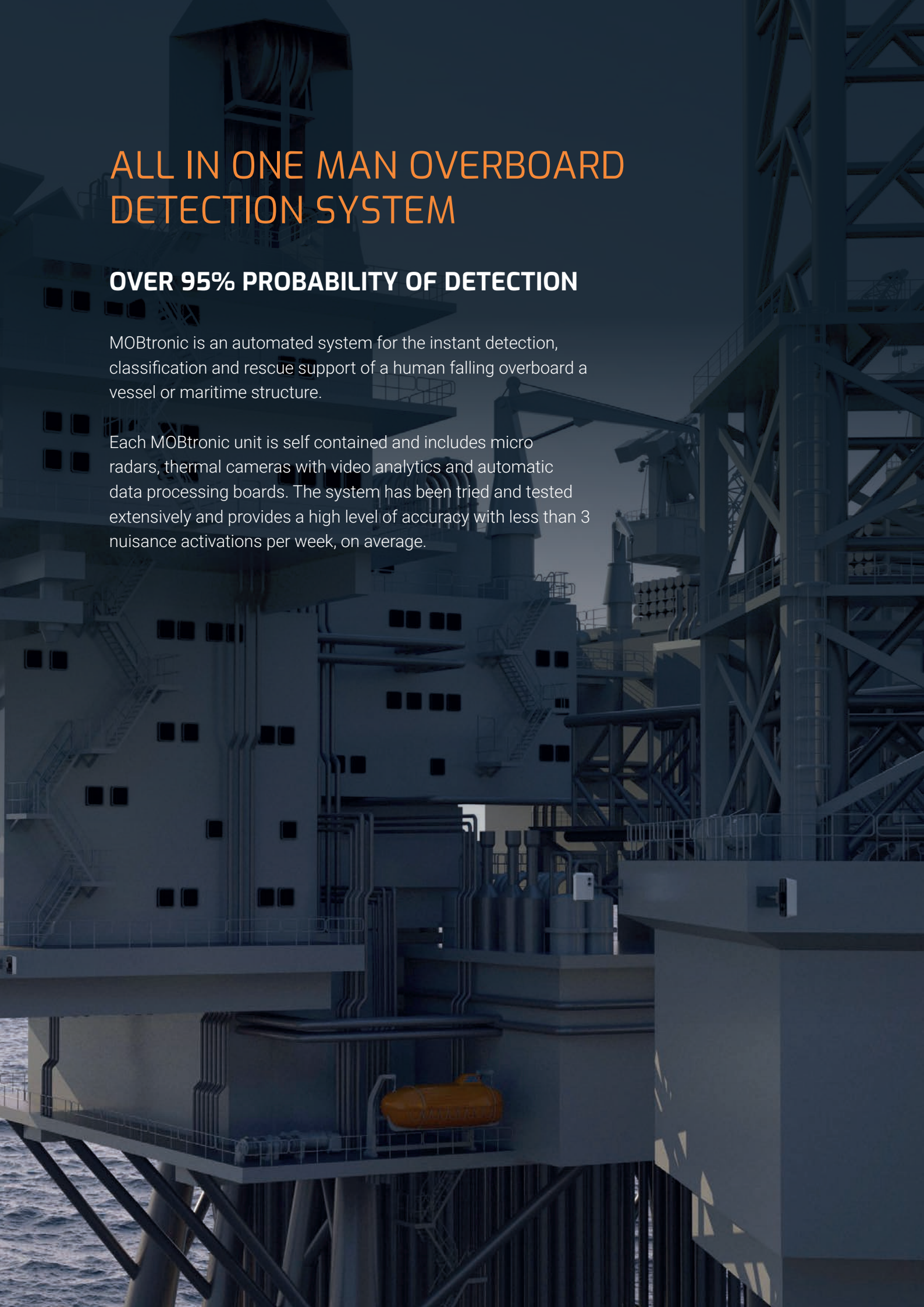

SYSTEM OVERVIEW

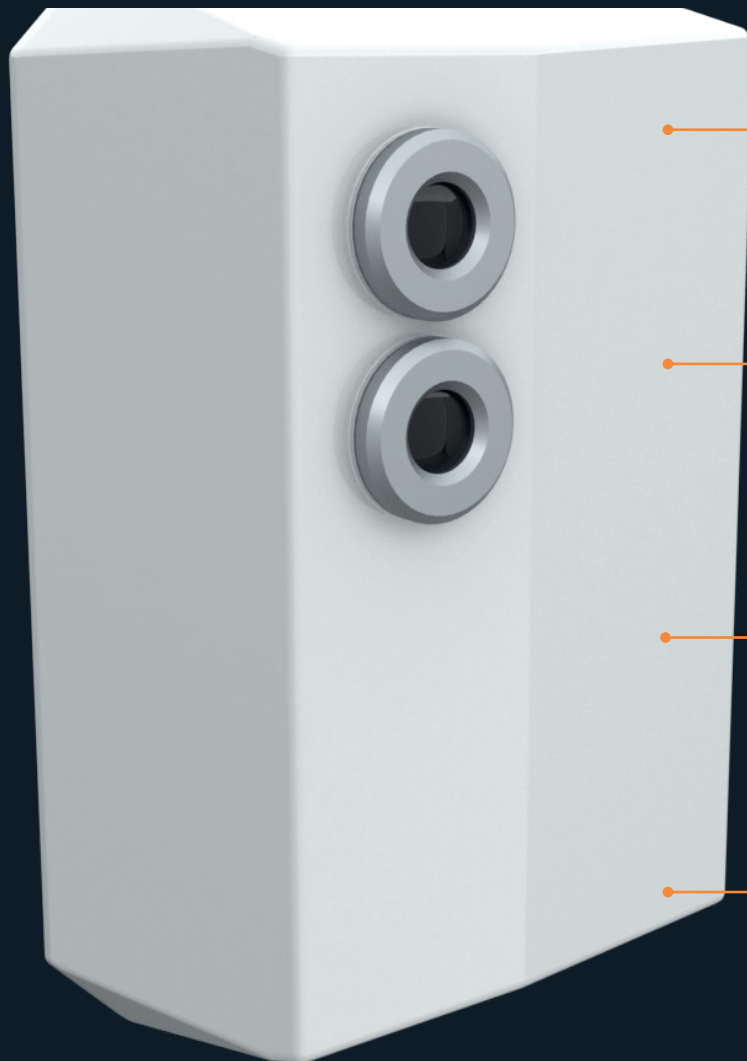

THERMAL CAMERA

Visuals in day/night with video analytics

MICRO-RADARS

High probability of detection for MOB

SINGLE BOARD COMPUTER

For automatic data processing

IP66/IP67 MARINISED UNIT

Integrated heat sink for passive cooling and shield against waves



MULTI-LAYER SAFETY SYSTEM

MOBtronic installations consist of multiple sensor stations mounted around a vessel at strategic locations. Events are tracked and classified according to motion, AI image classification and IR signature. Only potential human falls raise alarms, significantly reducing false positives.



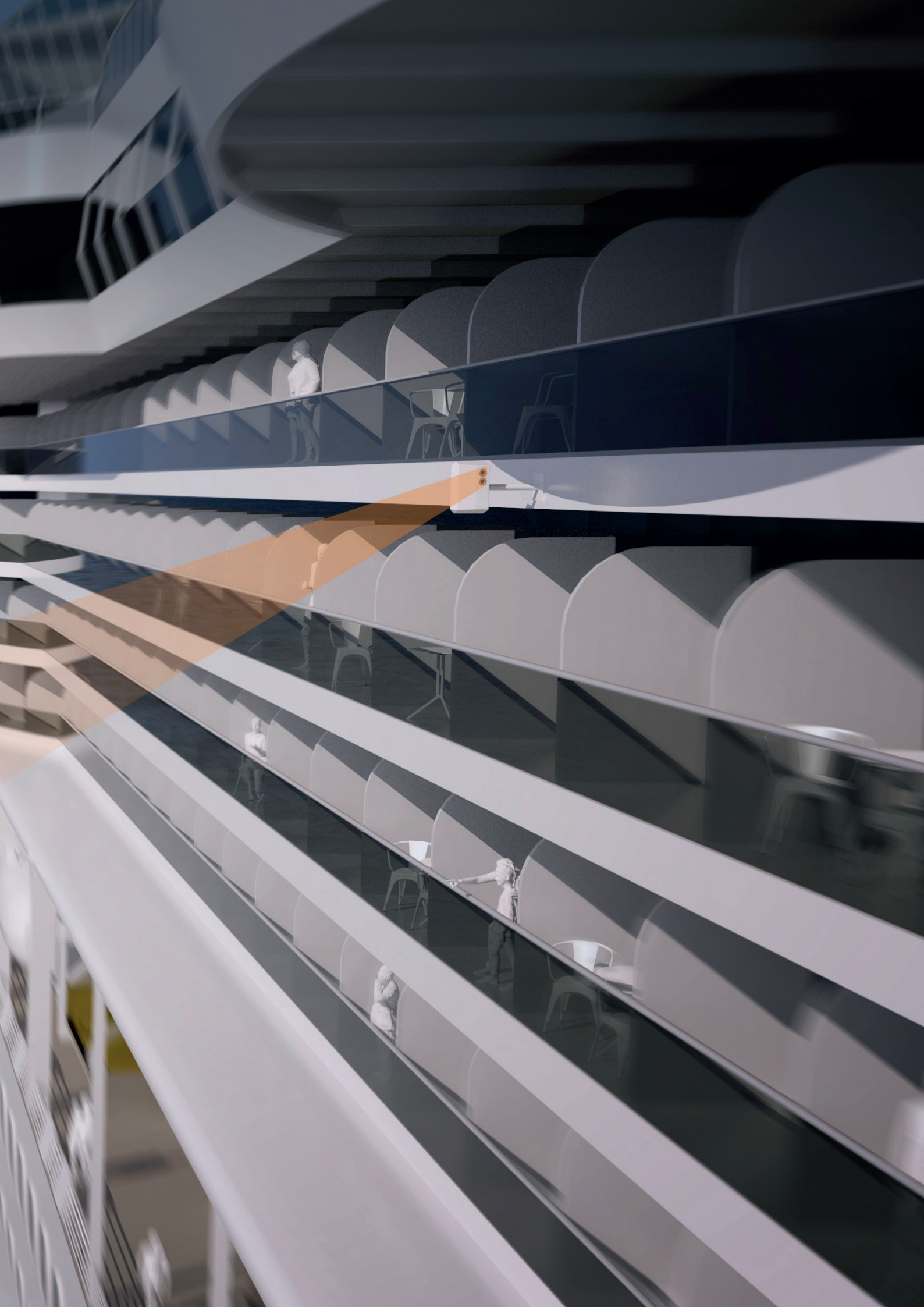

INSTALLATION

MOBtronic is integrated seamlessly onto a vessel for discreet safety. Each configuration, including the number of sensor stations, is developed in collaboration with our customers and installed based upon safety requirements.



MOBtronic



COMMAND &
CONTROL

CLIMBER DETECTION

AUTONOMOUS CLIMBER DETECTION SOLUTION

Using the same multi-sensor approach, CLiMBERguard can be added to a MOBtronic installation to instantly detect, classify and alert of onboarding activities on the side of a vessel or maritime structure.

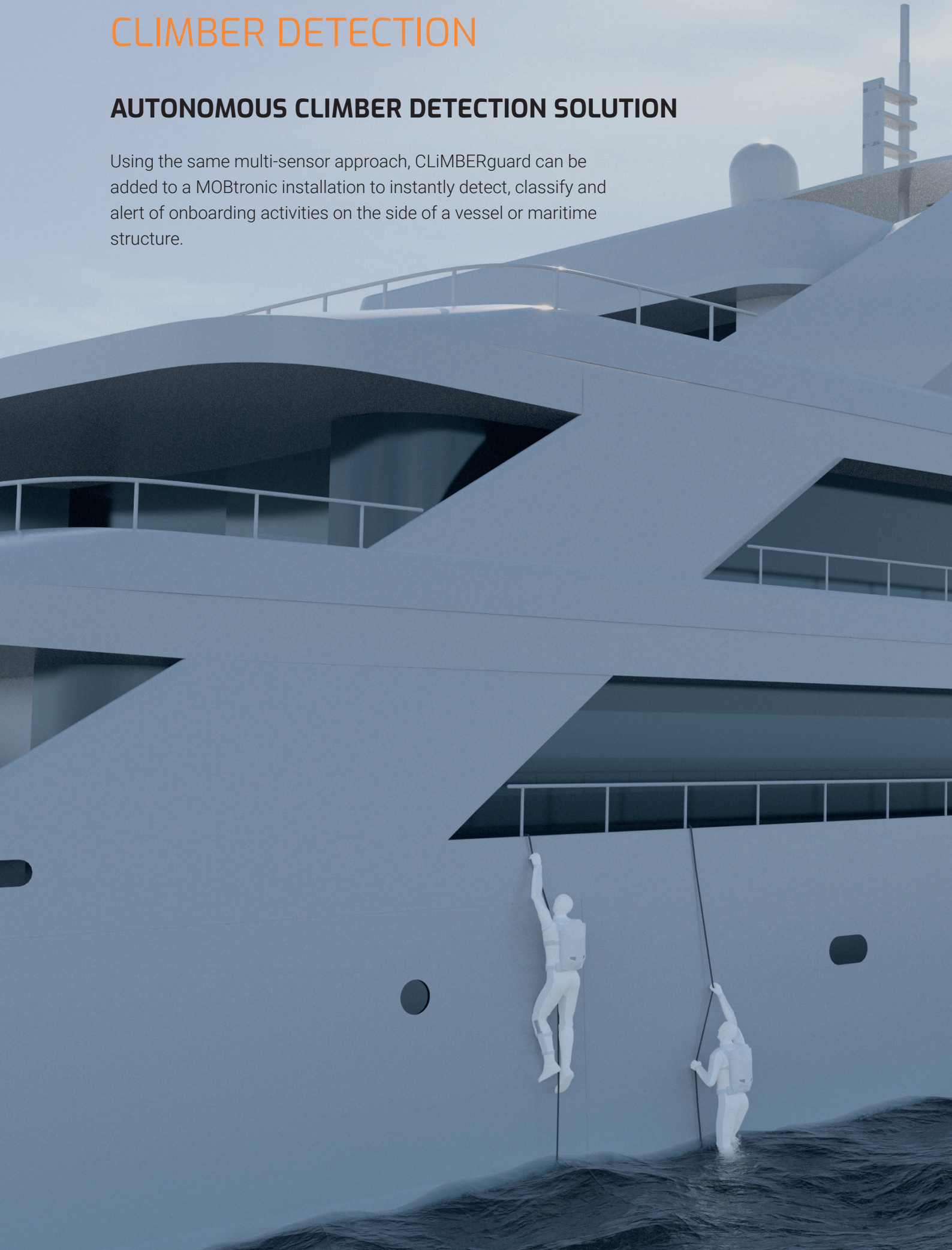

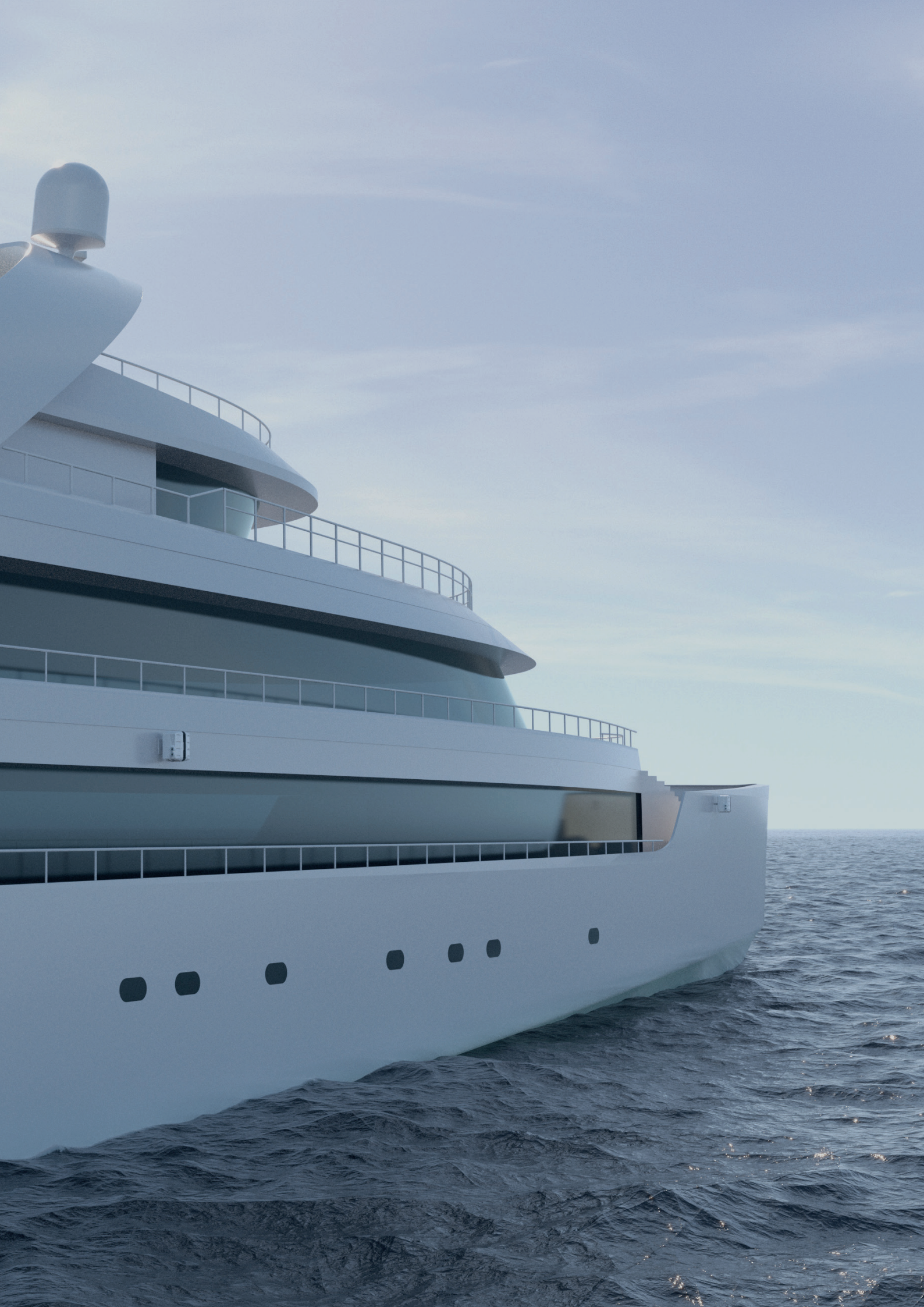



MARSS

MONACO
Villa C Olympea
6-8 Rue Augustin Vento
98000, Monaco

KSA
King Khalid Int. Rd.
Riyadh
Saudi Arabia

BRISTOL
40 Berkeley Square
BS8 1HP
Bristol, UK

LONDON
14 Curzon Street
W1J 5HN
London, UK

+377 93 50 52 22
Info@marss.com | marss.com

Specifications subject to change and product development. Copyright © MARSS 2022